

Assembly / Storage Hutch.4D (15" D x65"W x36"H,381Dx1650Wx917H)

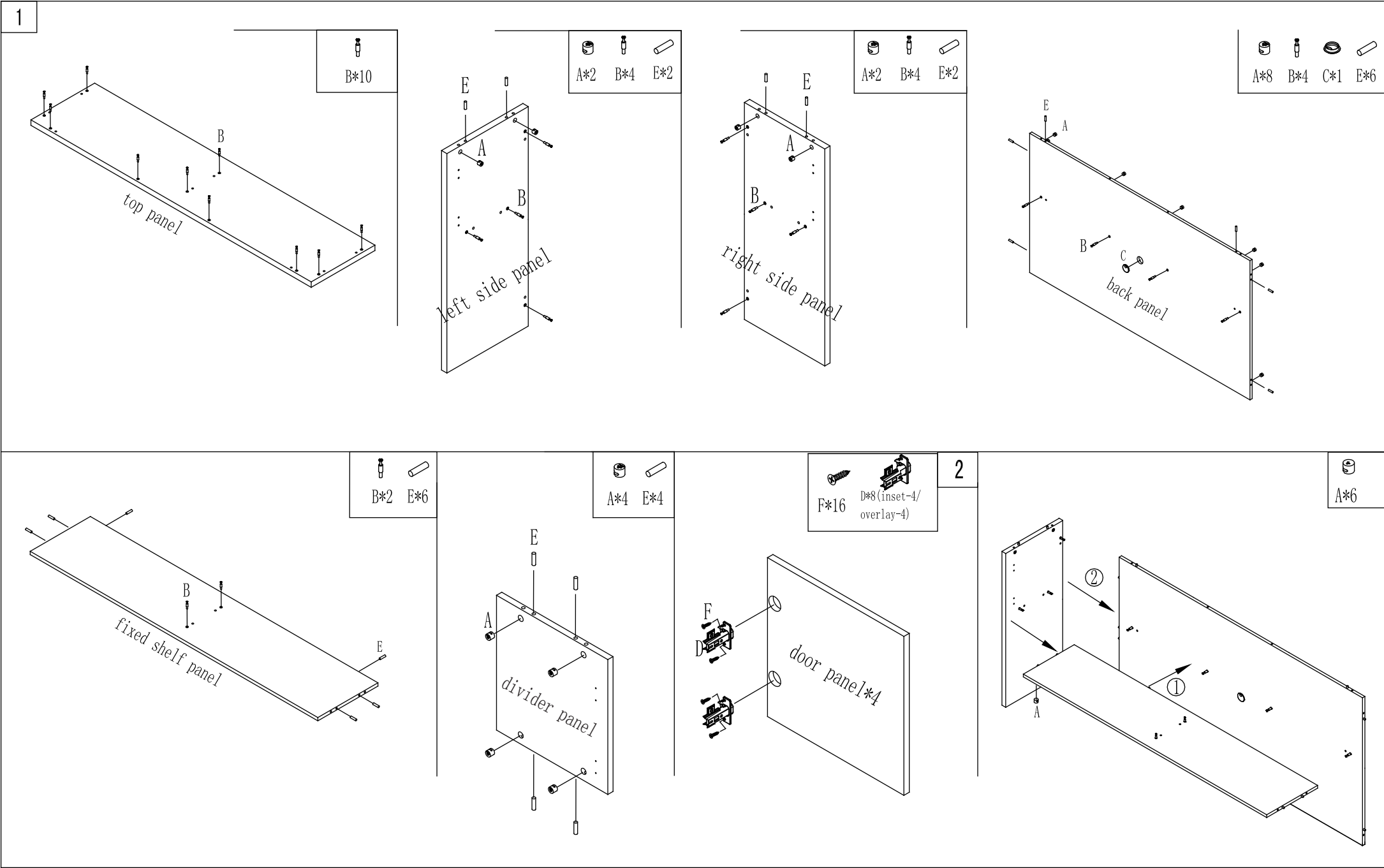

Assembly / Storage Hutch.4D (15 "D x65 "W x36 "H,381Dx1650Wx917H)

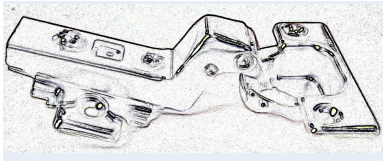
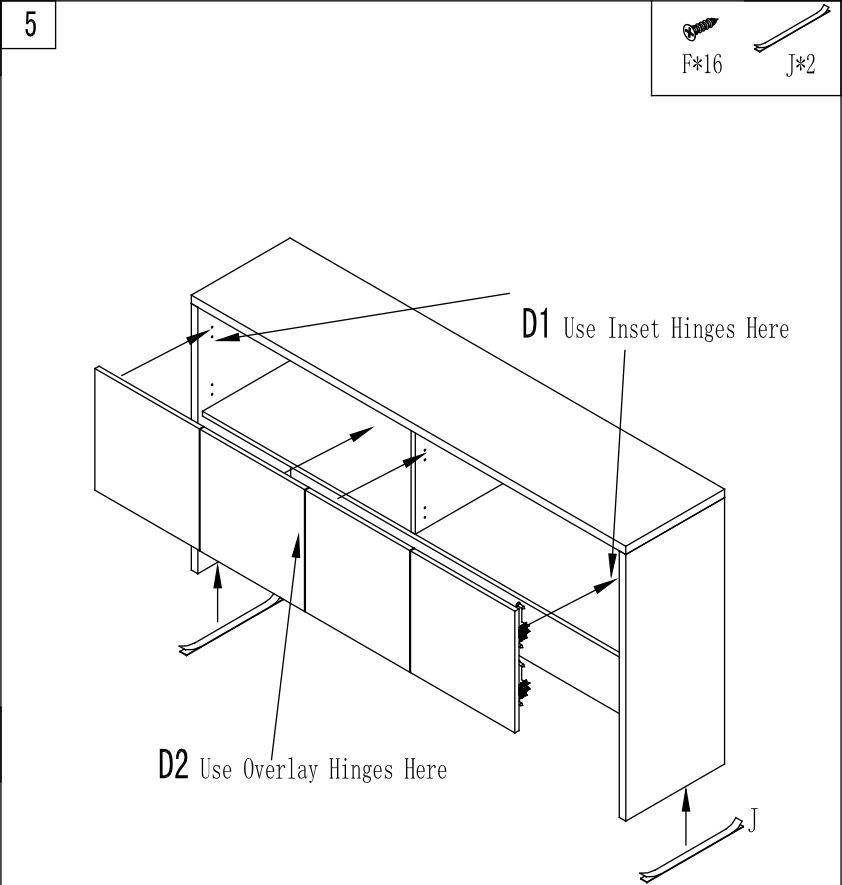
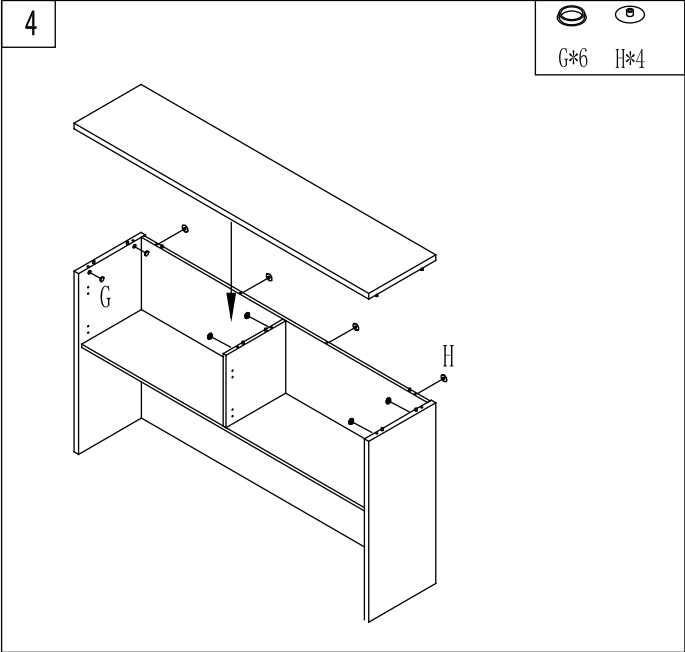
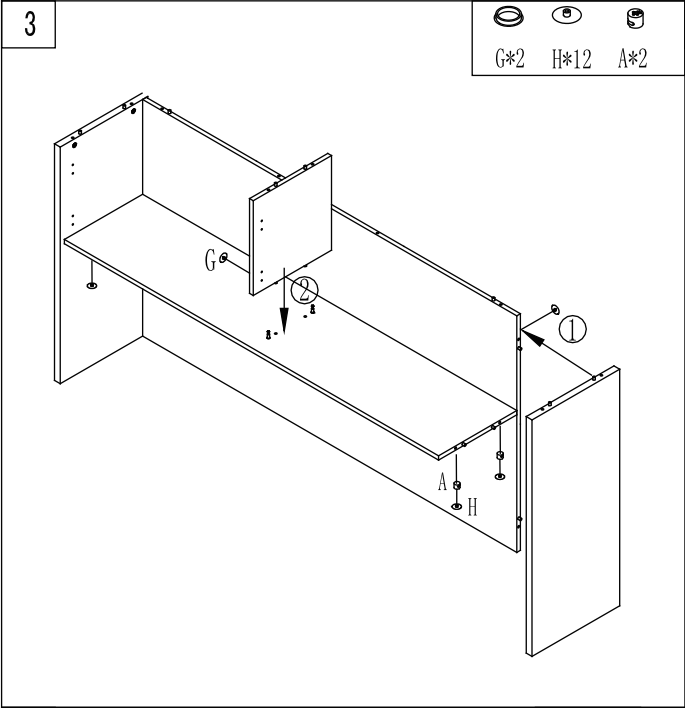

D1*4 Inset Hinges

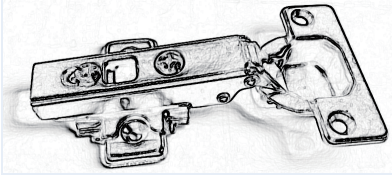

D2*4 Overlay Hinges

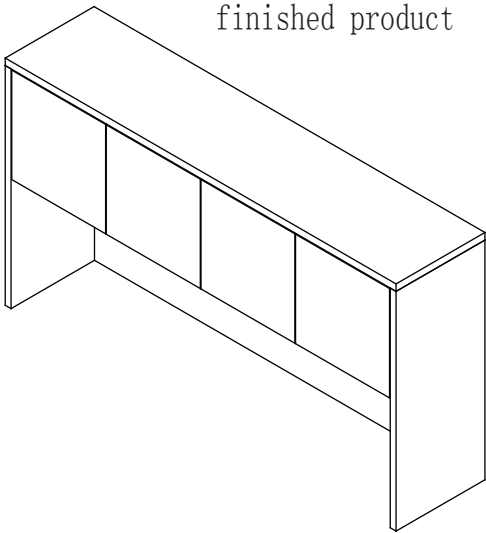

Hardware

N0.	sample. pc	name	QTY
A		Cam	24
B		Connector	24
C		Grommet 35mm	1
D1		Hinge(inset)	4
D2		Hinge(overlay)	4
E		Dowel	20
F		Screw(ST4*13)	32
G		Cam lid(deep)	8
H		Cam lid(low)	16
J		Double stick tape	2